



yellowstoneartmuseum



401 North 27th Street • Billings, MT 59101
Phone: 406.256.6804 • Fax: 406.256.6817
marketing@artmuseum.org • www.artmuseum.org

Accessibility Policy

The Yellowstone Art Museum welcomes visitors of all abilities and offers multi-sensory experiences. Our site is ADA-compliant and fully accessible.

Accessibility contact

The YAM's onsite accessibility contact is our Education Director, who can be reached at 406.256.6804 x231 or education@artmuseum.org.

Facilities and Equipment

Both of the YAM's buildings, located at 401 North 27th Street and 505 North 26th Street, are fully wheelchair accessible. Bench seating is available throughout the venues.

Parking

The YAM's parking lots are wheelchair-friendly. Designated parking spaces in the main museum lot are located to the left (north) when entering from the North 27th Street driveway. Designated parking spaces in the Visible Vault lot are on the north side of the lot, which is the side closest to the building.

Signage and printed materials

Both interpretive and directional signage have enlarged print, with the exception of some safety-related directional signage. The content of printed brochures and interpretive material is accessible on the YAM website or can be provided in enlarged print format, upon request.

Wheelchairs, walkers and strollers

Wheelchairs and walkers are available at our main museum building at 401 North 27th Street.

Custom-access tours

Please request custom-access tours two weeks in advance at 406.256.6804 x232 or artsuitcase@artmuseum.org.

Tours for the Visually Impaired

The galleries are furnished with an ever-changing array of hands-on stations. Contact us to discuss how we can provide an enjoyable guided visit that will meet your needs, such as tactile tours or sit-down studio experiences.

Materials for the Hearing Impaired

Interpretive signage and detailed object labels using large, readable fonts are present in all galleries. The YAM is not currently equipped to provide audio tours, TTY, or listening devices, but we are delighted to offer docent or staff-led tours with two-weeks' notice.

Service & Emotional Support Animals

Service Animals

The Yellowstone Art Museum complies with all ADA requirements and accepts service animals.

Emotional Support Animals

The Yellowstone Art Museum does not allow Emotional Support Animals on site, as they are not considered service animals under the ADA.



Digital Map

2nd
Floor

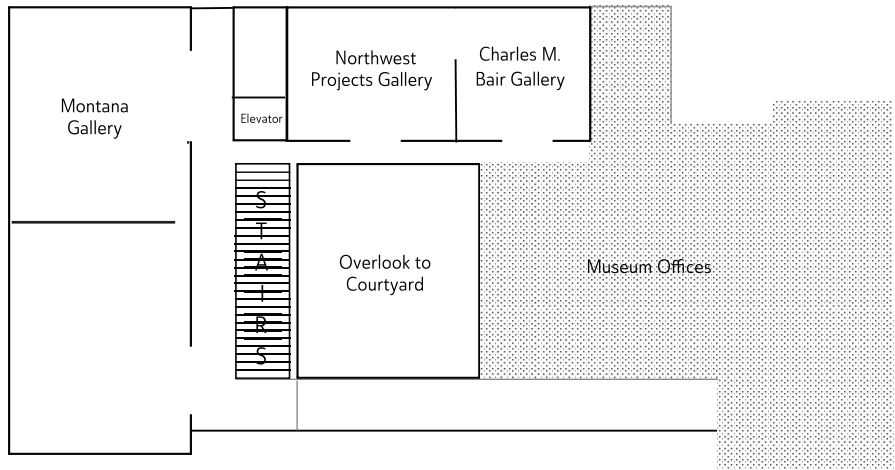

1st
Floor

